

# TRAFFIC REMOVABLE BOLLARDS

## partially submerged



RELIABLE, PRACTICAL AND COST-EFFECTIVE SOLUTION TO  
PROVIDE 100% SECURITY OF YOUR TERRITORY

TiSO removable traffic bollards are one more interesting solution for vehicle access control management. The main difference to regular fixed/static bollards determined by mobility which provides free driveway in case of necessity. To get bollard unlocked, the only thing which has to be done is a simple turn of a key. The range of removable bollards available in different dimensions, blocking heights, tube's materials, and diameters. The installation depth is 315 mm.

Intended for vehicle access control with little traffic intensity.

### Installation areas

- Governmental Institutions
- Military Bases
- Nuclear Power Plants
- Production sites (Industrial Plants)
- Commercial areas
- Financial institutions
- Airport Premises
- Business (Office) Center
- Hotels
- Sport Complexes
- Recreation areas
- Urban areas
- Education Institutions



www.tiso.global  
+380 (44) 291-21-11  
e-mail: sales@tiso.global



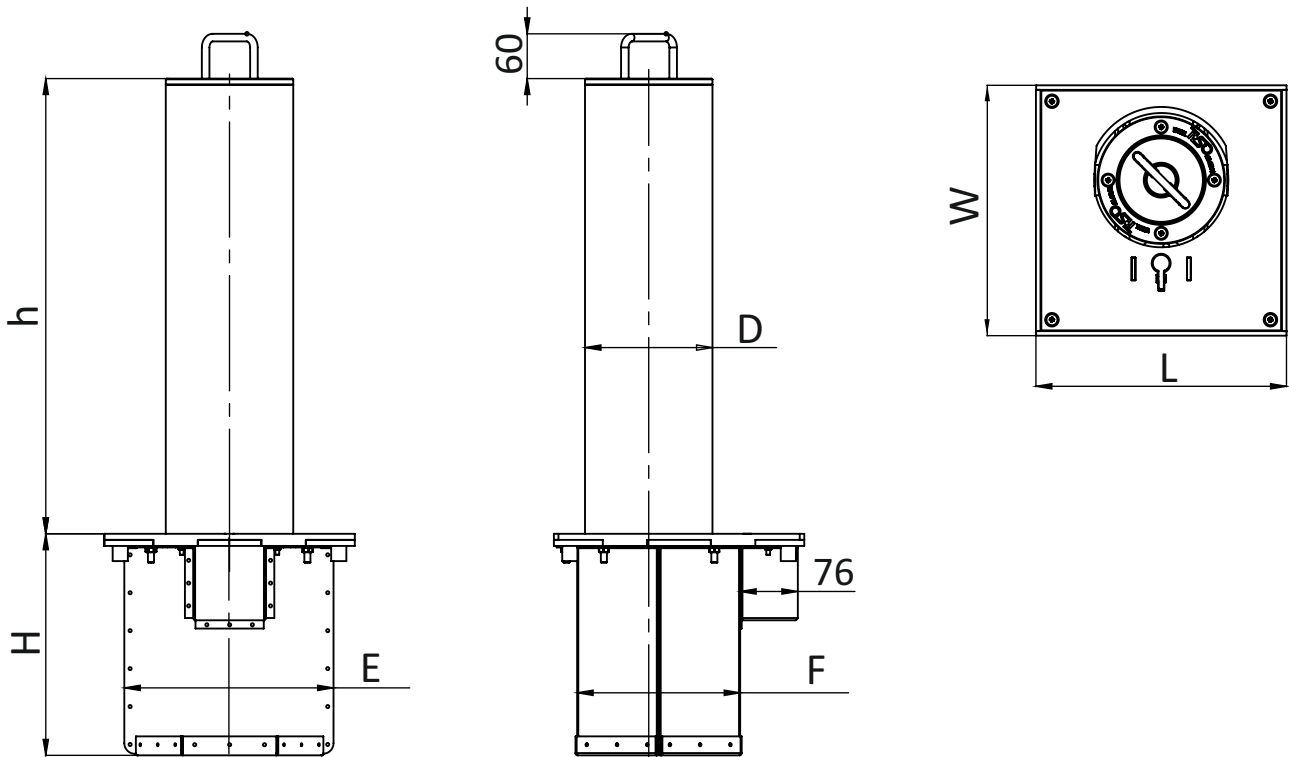

**TECHNICAL SPECS:**

| Model                  | RB345-03  | RB345-02 | RB345-01    | RB345-15 | RB345-06    | RB345-05 | RB345-04    | RB345-18 |
|------------------------|---|----------|-------------|----------|-------------|----------|-------------|----------|
| Tube diameter (D), mm  | 114   | 170      | 220         | 273      | 114         | 170      | 220         | 273      |
| Tube height (H), mm    | 600   |          |             |          | 800         |          |             |          |
| Dimensions (LxWxH), mm | 330x330x290   |          | 380x400x290 |          | 330x330x290 |          | 380x400x290 |          |
| Dimensions (ExF), mm   | 275x215   |          | 350x280     |          | 275x215     |          | 350x280     |          |
| Materials              | Brushed stainless steel AISI 304<br>Brushed stainless steel AISI 316<br>Galvanized and powder coated tube (any RAL up on request) |          |             |          |             |          |             |          |

